

15304 LOS ANGELES DR, LOXAHATCHEE, FL, 33470

<https://igorpresman.com>

15304 Los Angeles
Dr, Loxahatchee,
FL, 33470

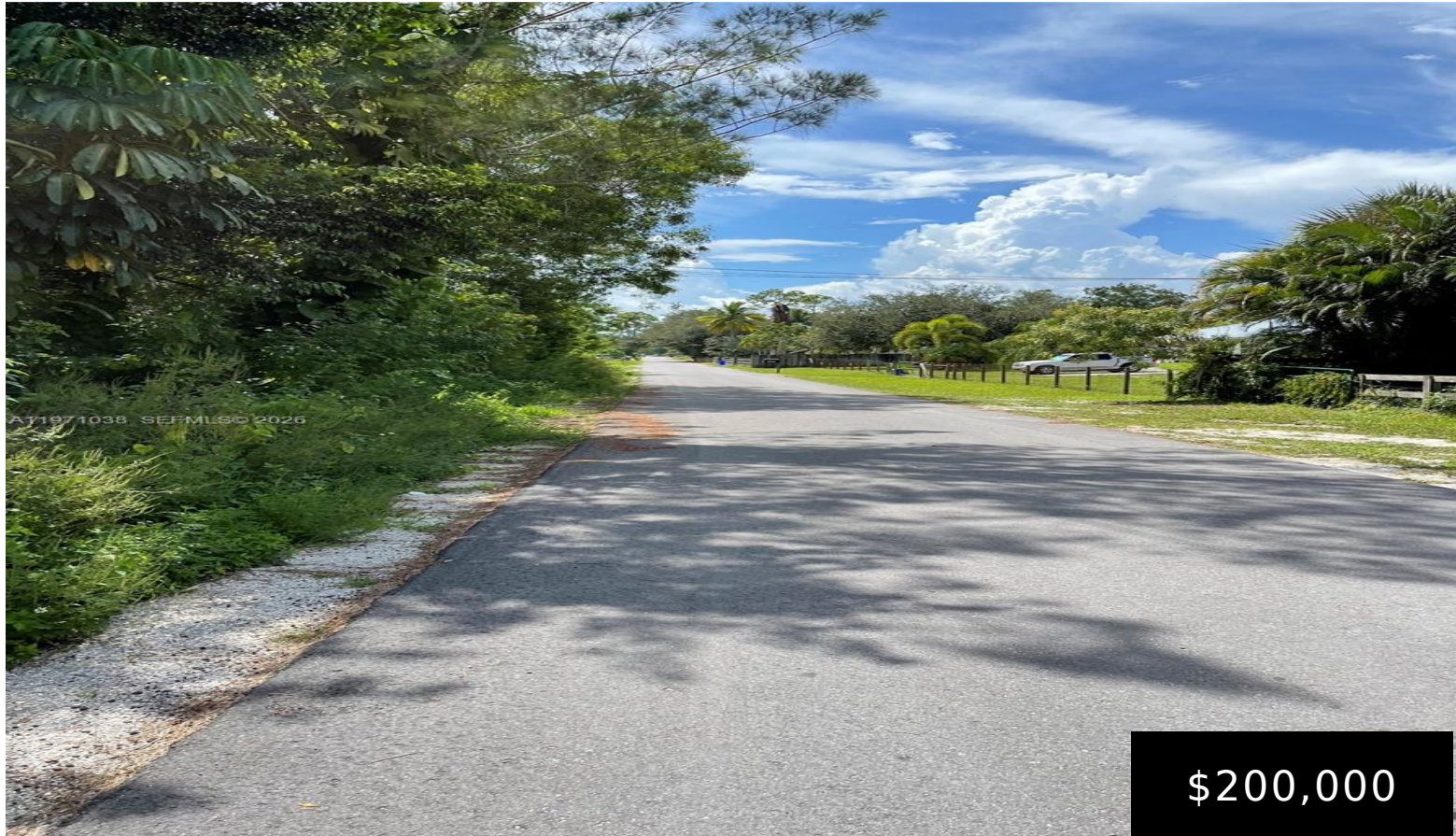

AT11971038 SEPMLS© 2026

\$200,000

Opportunity to build in popular Loxahatchee Groves location. minutes from all the amenities and shopping of Wellington /Royal Palm in a country setting. new construction on street, paved road, possibility of adjacent lots availability

- Land/Boat Docks
- Residential
- Active



Building Details

NewConstructionYN: No

Building Name: LOXAHATCHEE GROVES

Amenities & Features



Waterfront available: No

AttachedGarageYN: No

PoolPrivateYN: No

GarageYN: No

CoolingYN: No

FireplaceYN: No

