

600 PARKVIEW DR, HALLANDALE BEACH, FL, 33009

<https://igorpresman.com>

600 Parkview Dr,
Hallandale Beach,
FL, 33009

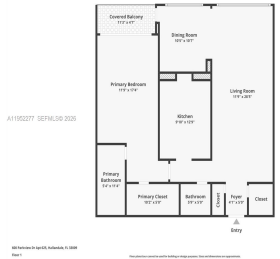
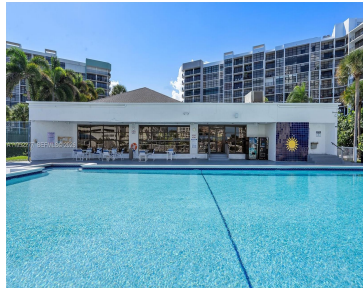

Generously sized 1 bedroom plus den, 1.5 bath condo (TAX RECORD SHOWS 2 BEDS) offering 1075 sq ft of living space. The versatile den area can be easily converted into the second bedroom, office, or a guest room. Maintenance includes: internet, cable, water, trash, exterminator. This well maintained building ideally located just minutes drive to [...]

- 2 beds
- 1 bath
- Residential
- Condominium
- Active
- 1075 sq ft



Building Details

Cooling features: Electric

NewConstructionYN: No

Heating: Electric

Parking: 1 Space, Deeded, Guest

ArchitecturalStyle: High Rise

Building Name: TOWERS OF OCEANVIEW SOUT

Exterior material: Concrete Block Construction



Amenities & Features

Features: Den/Library/Office, Lobby, Walk-In Closet(s)

Amenities: Dishwasher, Electric Range, Electric Water Heater, Microwave, Refrigerator

ExteriorFeatures: East Of Us1, Open Balcony

GarageYN: No

CoolingYN: Yes

FireplaceYN: No

Security Features: Doorman, Lobby Secured

WindowFeatures: Blinds

Waterfront available: No

AttachedGarageYN: No

PoolPrivateYN: No

